

User's Manual

XPOS72A-5B-2930

XPOS72A-5B-1900



Copyrights

©2015 All rights reserved. The information in this document is subject to change without prior notice in order to improve reliability, design and function and does not represent a commitment on the part of the manufacturer.

This document contains proprietary information protected by copyright. All rights are reserved. No part of this manual may be reproduced by any mechanical, electronic, or other means in any form without prior written permission of the manufacturer.

All trademarks are property of their respective owners

Liability Disclaimer

In no event will the manufacturer be liable for direct, indirect, special, incidental, or consequential damages arising out of the use or inability to use the product or documentation, even if advised of the possibility of such damages.

Regulatory Information

FCC Notices



This equipment has been tested and found to comply with the limits for a Class A digital device, pursuant to Part 15 of the Federal Communications Commission (FCC) Rules. These limits are designed to provide reasonable protection against harmful interference in a residential installation. This equipment generates, uses, and can radiate radio frequency energy and, if not installed and used in accordance with the instructions, may cause harmful interference to radio communications. However, there is no guarantee

that interference will not occur in a particular installation. If this equipment does cause harmful interference to radio or television reception, which can be determined by turning the equipment off and on, the user is encouraged to try to correct the interference by one or more of the following measures:

- Increase the separation between the equipment and the receiver.
- Connect the equipment into an outlet on a circuit different from that to which the receiver is connected.
- Consult the dealer or an experienced radio or television technician for help.

This device complies with Part 15 (A) of the FCC Rules. Operation is subject to the following two conditions:

- 1) this device may not cause harmful interference and
- 2) this device must accept any interference received, including interference that may cause undesired operation.

NOTE: THE MANUFACTURER IS NOT RESPONSIBLE FOR ANY RADIO OR TV INTERFERENCE CAUSED BY UNAUTHORIZED MODIFICATIONS TO THIS DEVICE. SUCH MODIFICATIONS COULD VOID THE USER'S AUTHORITY TO OPERATE THE DEVICE.

CE Notice



This device complies with **EMC Directive 2004/108/EC** issued by the Commission of the European Community.

WEEE Notice



The **WEEE** mark applies only to countries within the European Union (EU) and Norway.

This appliance is labeled in accordance with

European Directive 2002/96/EC concerning **waste electrical and electronic equipment (WEEE)**. The

Directive determines the framework for the return

and recycling of used appliances as applicable

throughout the European Union. This label is applied

to various products to indicate that the product is not

to be thrown away, but rather reclaimed upon end of

life per this Directive.

Contents

Copyrights	ii
Liability Disclaimer	ii
Regulatory Information	ii
FCC Notices.....	ii
CE Notice	ii
WEEE Notice.....	iii
Contents	iv
1. Hardware Setup	5
1.1. Quick Tour	5
Front View	5
Back View	5
Back Panel I/O	6
1.2. Basic Peripherals Installation	6
Power Adapter	7
USB Mouse, USB Keyboard and USB ODD	7
LAN Cable.....	7
Cash Drawer	8
Customer Display.....	8
MSR	10
1.3. Adjust Angle	12
1.4. Turn on the device	12
4. I/O Definition	13
2.1. Serial Port	13
2.2. Cash Drawer	13
5. Specification	16

Hardware Setup

1.1. Quick Tour Front View

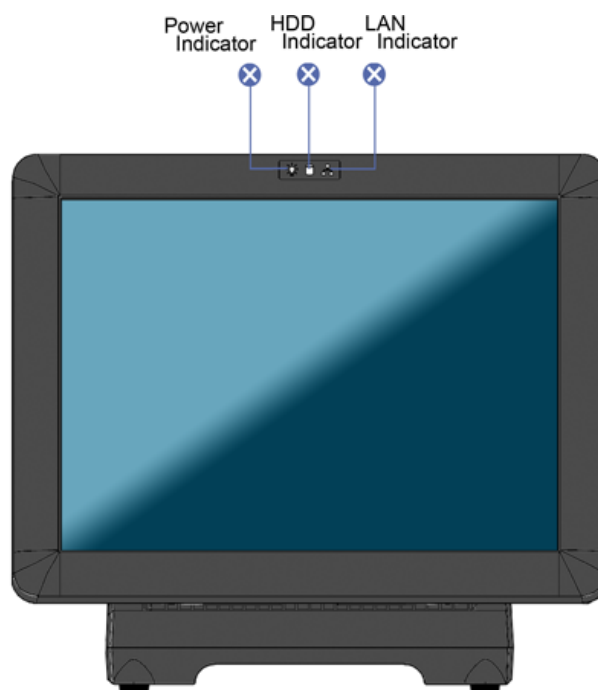

LED Indicator



The **Power** indicator will glow green when power is on.



The **HDD** indicator will blink green when the HDD is accessed.



The **LAN** indicator will blink green when transferring data through the LAN.

Back View

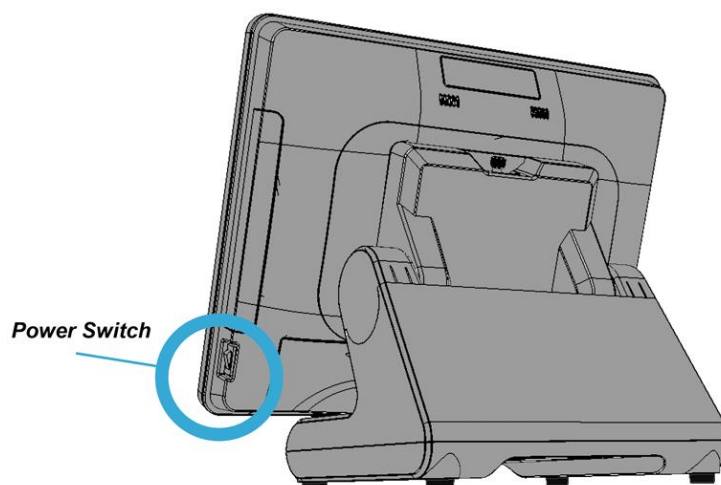

Back Panel I/O

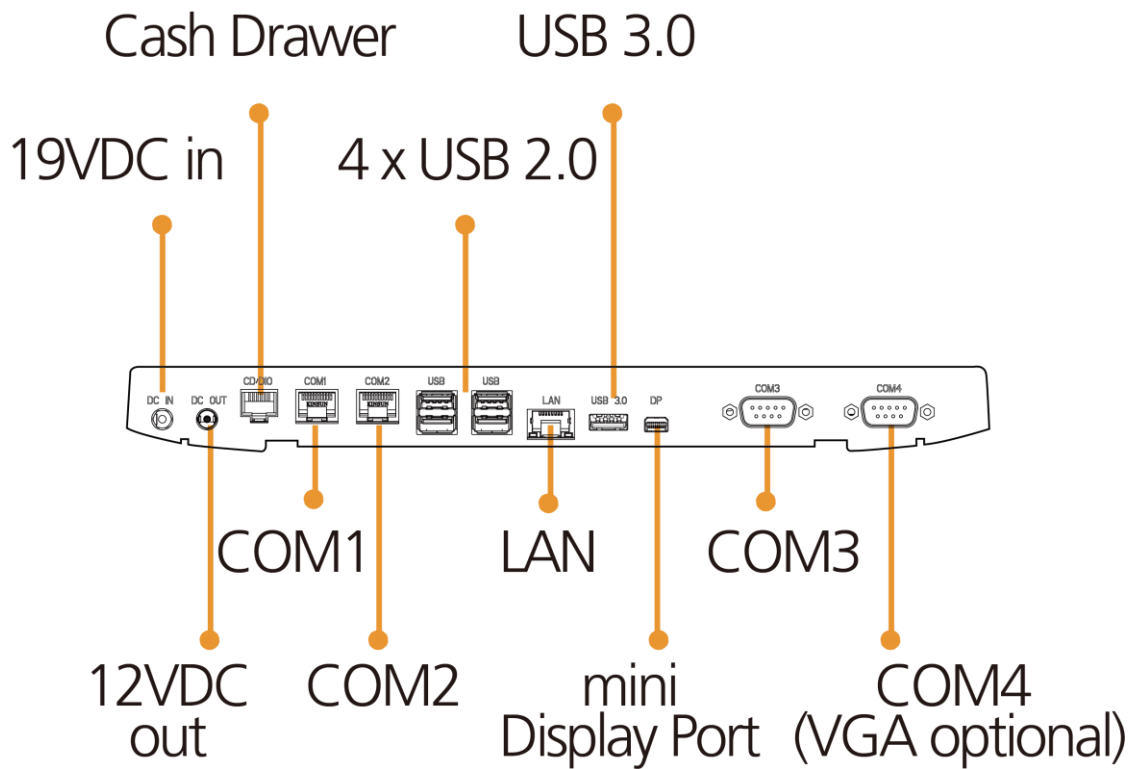

1.2. Basic Peripherals Installation

All cables and wires from peripherals to the POS device are recommended to be connected as the direction as shown below.

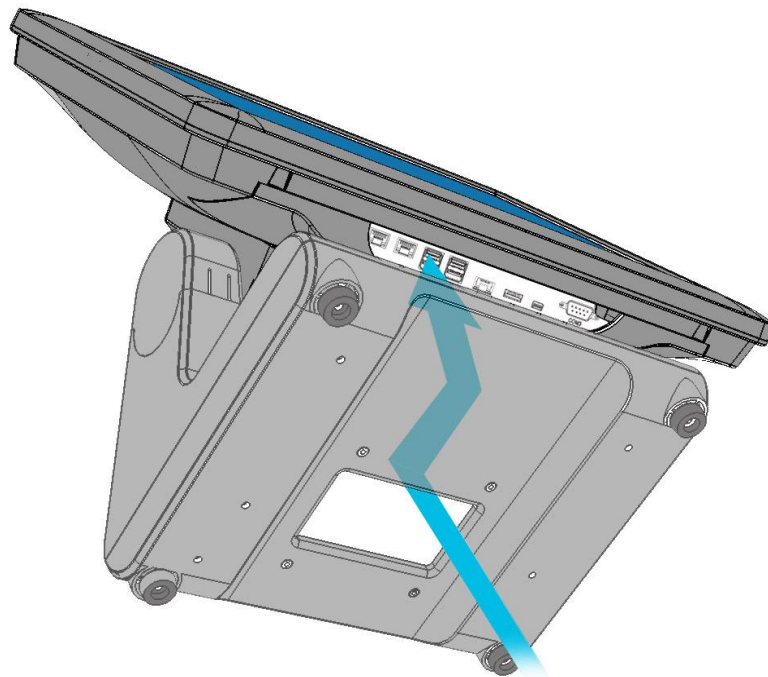

Power Adapter

Connect the 4-pin output jack of the adapter to the **DC 19V** jack on the back panel of the device.

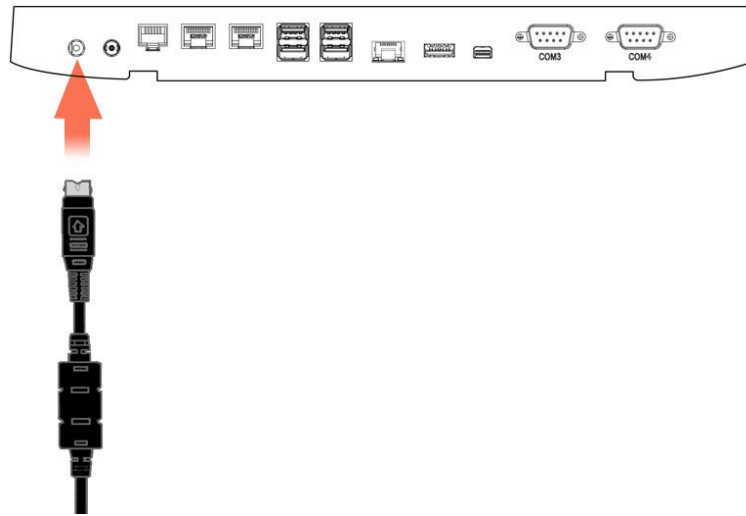

USB Mouse, USB Keyboard and USB ODD

Connect your USB Mouse, USB Keyboard and USB ODD to **USB** ports on the back panel of the device.

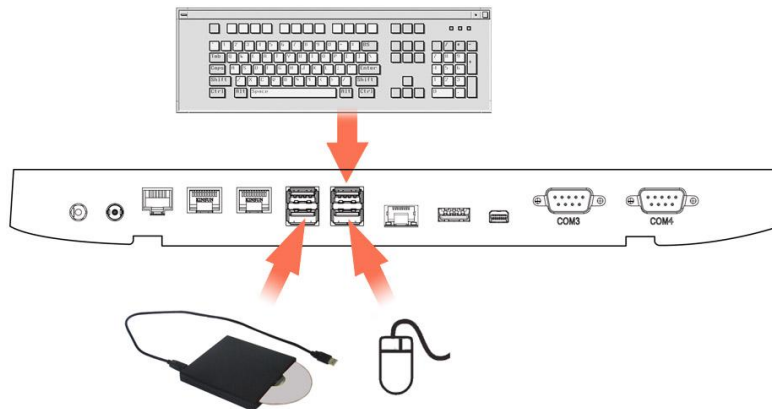

LAN Cable

Connect one end of RJ-45 LAN cable to the **LAN** port on the back panel of the device, another end to your internet device.

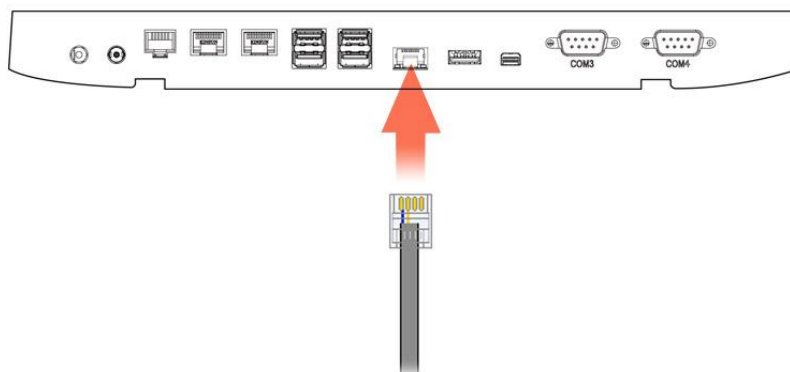

Cash Drawer

Connect one end of RJ-12 cable to the **Cash Drawer** port on the back panel of the device, another end to your cash drawer.

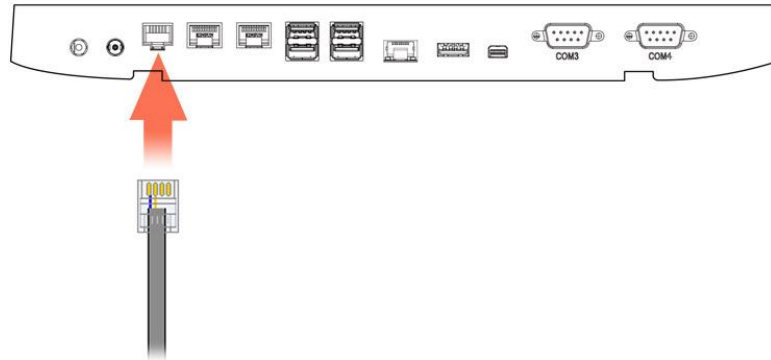

Customer Display

1. Remove the customer display mounting hole cover from the device and pull out the connector from the device.

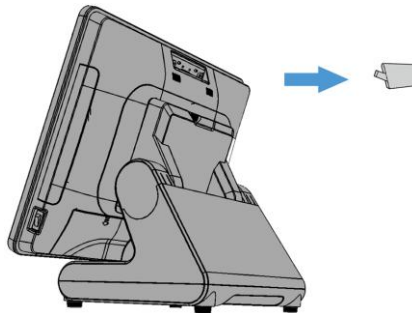

2. Adjust the hinge of the customer display, and then connect to the device as shown below.

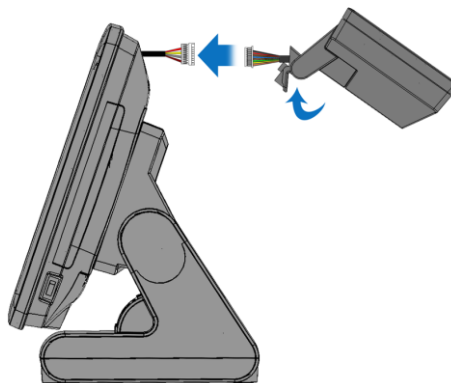

3. Mount the customer display to the device and tighten the two PHILLIPS M3 screws as shown below.

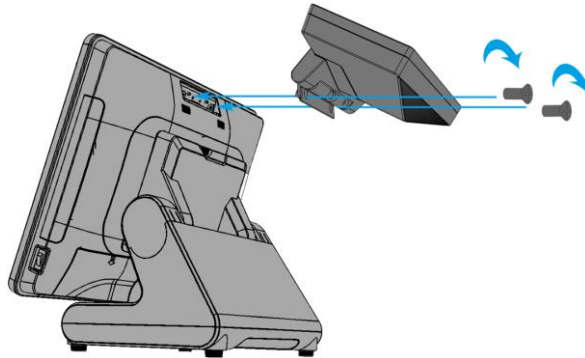

4. Finished.

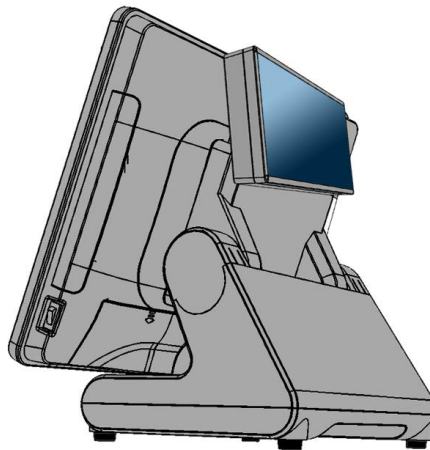

B. Power Supply Configuration

Power up the device and hit the DEL key to enter the BIOS. When the BIOS screen appears use the TAB key to select Advanced. Use the arrow keys to select Super IO Configuration then type ENTER. The screen below will appear. Use the arrow keys to select **Serial Port 6** RI/12V depending on what port the customer display is connected to. Select 12V to enable power to the correct COM port. Type F10 to save the settings and exit the BIOS setup.

Caution: Never enable the 12 V without the customer display attached and be sure to disable the 12 V before removing the customer display.

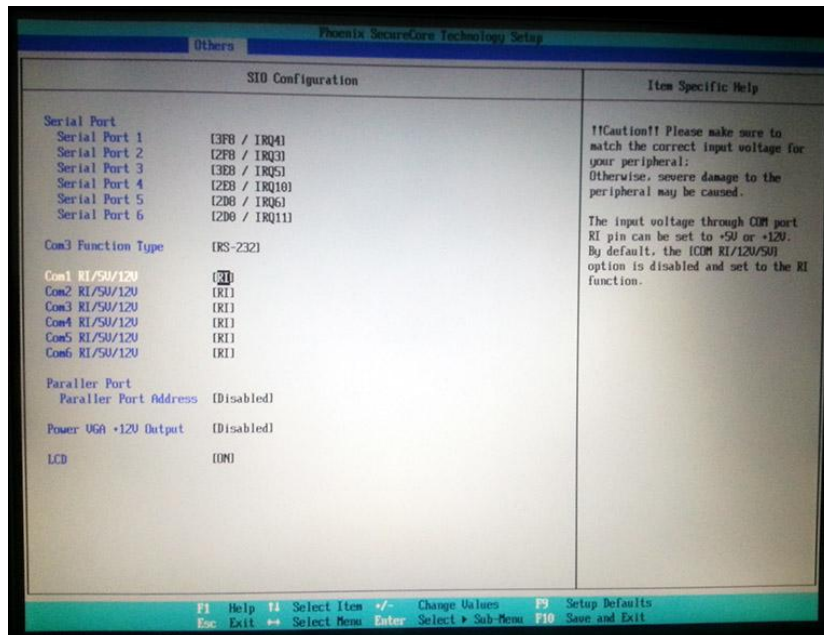

NOTE: The figure above is for reference only; it is possible that the actual screen on your device does not agree with it.

MSR

1. Remove the MSR cover from the device.

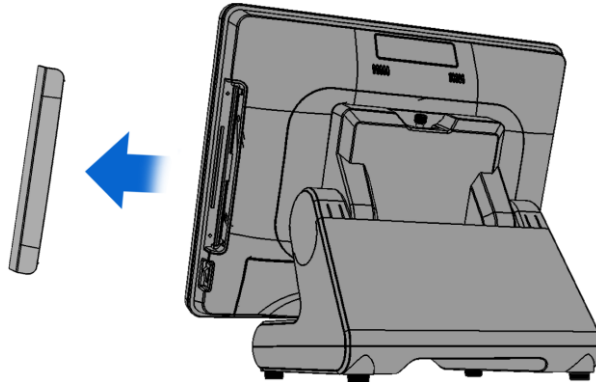

2. Connect the cable of the MSR assembly to the device.

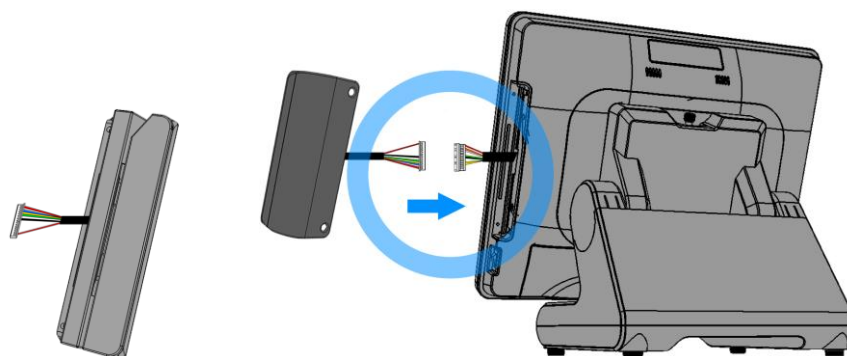

MSR

3. Tighten the two PHILLIPS M3 screws to fix the MSR assembly as shown below.

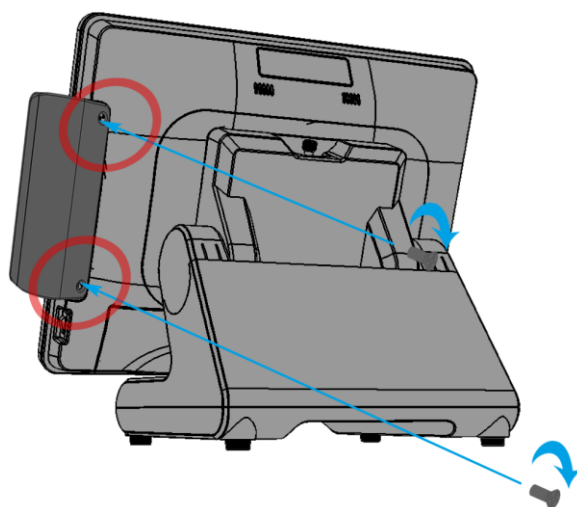

4. Finished.

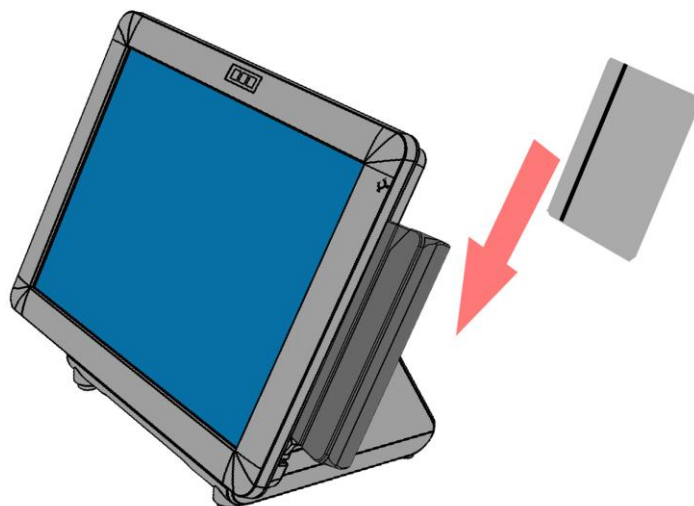

Note:

The RS232 MSR is powered by **COM5**, Baud rate is 9000, 8, n, 1.

1.3. Adjust Angle

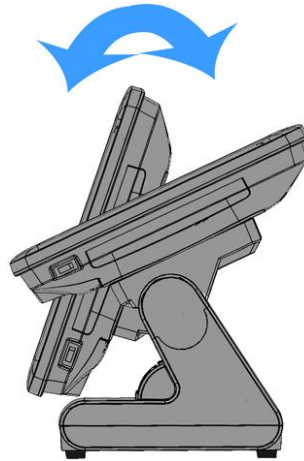

1.4. Turn on the device

1. Make sure all peripherals are connected properly.
2. Press and hold the power switch until the power indicator on the front panel glow green.

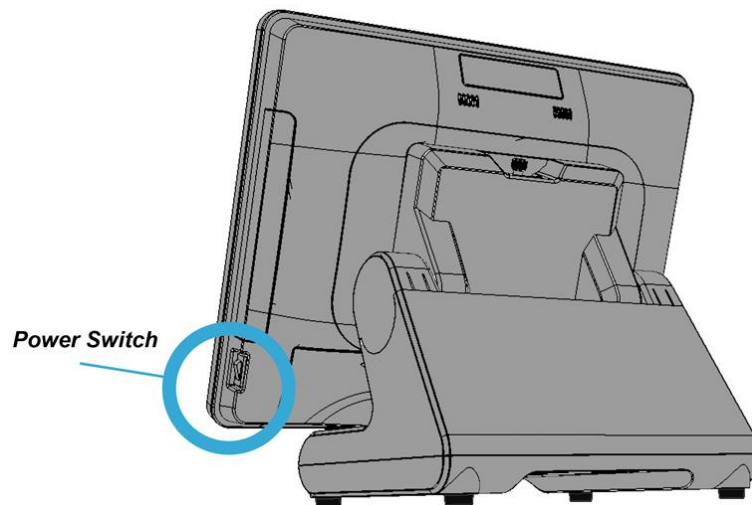

I/O Definition

Please refer the detailed technical information about all I/O ports as followings.

2.1. Serial Port



COM Port			
PIN	Description	PIN	Description
1	DCD	6	DSR
2	RXD	7	RTS
3	TXD	8	CTS
4	DTR	9	RI / 5V /12V
5	GND	10	NC

PIN	R232	RS422	RS485
1	DCD	TX-	D-
2	RXD	TX+	D+
3	TXD	RX+	
4	DTR	RX-	

2.2. Cash Drawer

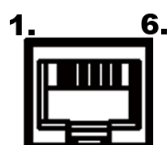

PIN	Description	PIN	Description
1	GND	4	12V / 19V
2	D_OUT0	5	D_OUT1
3	D_IN	6	GND

Cash Drawer Control

The Cash Drawer Controller use one I/O addresses to control the Cash Drawer.

Register Location: 48Ch

Attribute: Read / Write

Size: 8-bit

BIT	BIT7	BIT6	BIT5	BIT4	BIT3	BIT2	BIT1	BIT0
Attribute	Reserved	Read	Reserved	Reserved	Write	Write	Reserved	Reserved

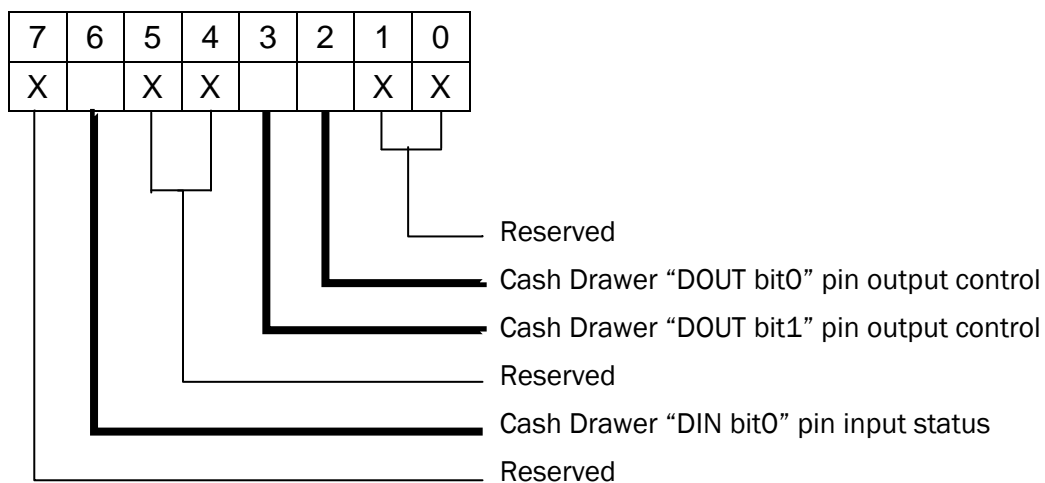

BIT7: Reserved

BIT6: Cash Drawer "DIN bit0" pin input status.

= 0: the Cash Drawer closed or no Cash Drawer

= 1: the Cash Drawer opened

BIT5: Reserved

BIT4: Reserved

BIT3: Cash Drawer "DOUT bit1" pin output control.

= 1: Opening the Cash Drawer

= 0: Allow close the Cash Drawer

BIT2: Cash Drawer "DOUT bit0" pin output control.

= 1: Opening the Cash Drawer

= 0: Allow close the Cash Drawer

BIT1: Reserved

BIT0: Reserved

Note: Please follow the Cash Drawer control signal design to control the Cash Drawer.

Cash Drawer Control Command Example

Use Debug.EXE program under DOS or Windows98

Command	Cash Drawer
O 48C 04	Opening
O 48C 00	Allow to close
<ul style="list-style-type: none">➤ Set the I/O address 48Ch bit2 =1 for opening Cash Drawer by “DOUT bit0” pin control.➤ Set the I/O address 48Ch bit2 = 0 for allow close Cash Drawer.	

Command	Cash Drawer
I 48C	Check status
<ul style="list-style-type: none">➤ The I/O address 48Ch bit6 =1 mean the Cash Drawer is opened or not exist.➤ The I/O address 48Ch bit6 =0 mean the Cash Drawer is closed.	

Specification

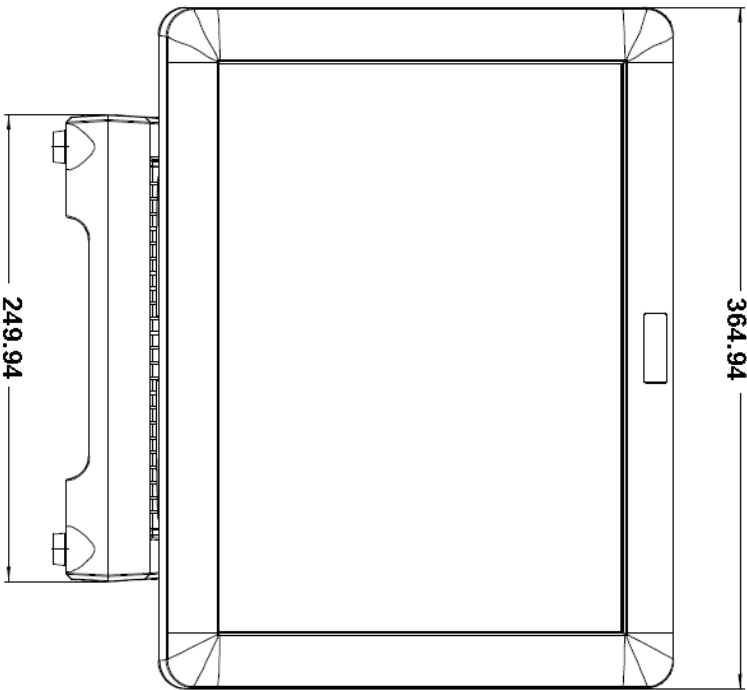
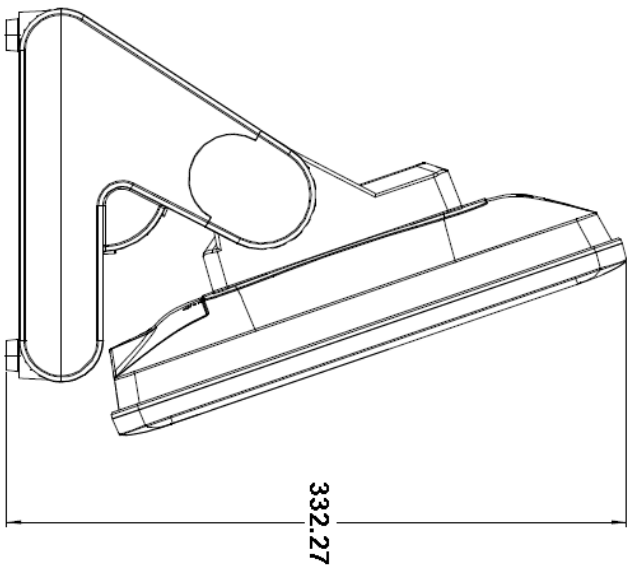

UNIT	mm
RANGE	TOLERANCES
0 – 10	± 0.10
10 – 50	± 0.15
50 – 100	± 0.20
100 –	± 0.25

Main Board	
CPU	Intel® Bay Trail-Mobile/Desktop SoC Processor: Celeron® N2930 (4 cores, up to 2.16 GHz, max TDP 7.5 Watt) Celeron® J1900 (4 cores, up to 2.42 GHz, max TDP 10 Watt)
Graphic	Intel® HD Graphics
System Memory	SO-DIMM DDR3L 1067/1333MHz x 1, Max. 8GB
Cooling Solution	Fan-less
OS	Windows Embedded POSReady 7 Windows 7 Professional for Embedded Systems Windows Embedded 8 Industry Linux kernel 3.0+ & associated distributions Android Compliant OS Window 10
Display	
Size	15" TFT LCD Panel
Brightness	250 nit
Resolution	1024 X 768
Panel backlight type	LED
Tilt Angle	17°~67°
Touch Screen	5 Wire Resistive
Storage Device	
Interface	SATAII (3.0Gb/S) x 2
HDD or SSD	2.5" SATA HDD / SSD x 1 mSATA slot x 1
I/O Ports	
Serial	RS-232 x 4, pin9 with RI/5V/12V selectable by BIOS COM 1 / 2 : RS232, RJ50 COM 3 : RS232/422/485, DB9 COM 4 : RS232, DB9
USB	USB 2.0 x 4 USB 3.0 x 1
LAN	Gigabit Ethernet by RJ-45 x 1, support Wake on LAN
Cash Drawer	RJ12 x 1, support 12V / 24V DC cash drawer
Audio	2 W Speaker x 2
VGA	DB15 x 1 optional for replace COM4
DP / HDMI	mini Display Port x 1 (supporting active converter cable to VGA,DVI, HDMI)
DC-in	19VDC input x 1, 2pins jack
DC-out	12VDC x 1 / 1A output
Color	Black
Material	Plastic / Aluminum
Certifications	CE / FCC / WEEE / RoHS
Dimension (W x D x H)	36.5 x 22.9 x 33.2 cm (14.4 x 9 x 13 inch)
Net Weight / Gross Weight	6.8 kg, 15.1 lb / 8.8 kg, 19.6 lb

Operation Temperature	0 to +40°C
Storage Temperature	-20o ~ 60oC,
Humidity	20% to 85% RH (non condensing)